

HUUM DROP kuumasuunaja

Kuumasuunaja kinnitatakse **DROP** kerise ülemise tagumise serva külge. Selle otstarve on kaitsta kerise taga olevat seinu ja laenuka liigse kuumuse eest.



♥ OF SAUNA

HUUM DROP heat diverter

The heat diverter is attached to the upper rear edge of **DROP** heater. Its purpose is to protect the wall behind the heater and the corner of the ceiling from excessive heat.

EE Kuumasuunaja paigaldamine

Kinnita seinu külge DROP kerise seinaraam. Tee vajalikud elektriühendused.

NB! Jälgi, et enne kerisega ühendamist läbiksid kaablid ka DROP kerise peegeldis olevat ava.

- 1 Kinnita peegeldi kerise tagumisele küljele.
- 2 Kinnita kuumasuunaja kerise külge.

Nüüd saad jätkata kerise paigaldamisega. Tõsta keris seinaraamile ning keera kinni seinaraami paremal küljel asuv turvapolt.

EN Installation of the heat diverter

Attach the frame of DROP heater to the wall. Make the necessary electrical connections.

NB! Make sure that the cables pass through the hole in the reflector of DROP heater before connecting to the heater.

- 1 Attach the reflector to the back side of the heater.
- 2 Attach the heat diverter to the heater.

Now you can continue with the installation of the heater. Place the heater on the wall frame and tighten the security bolt on the right side of the wall frame.



Made in Estonia, EU

info@huum.eu
huum.eu
#huumsauna

HUUM OÜ
Vahi tee 9, Tartumaa
60534, Estonia

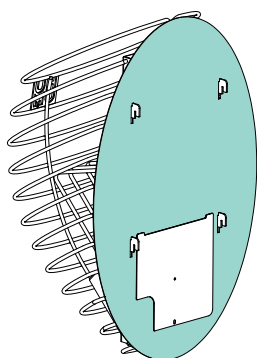
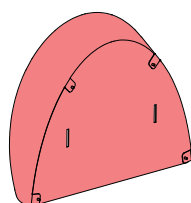

1

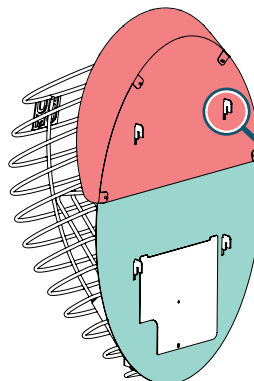

2

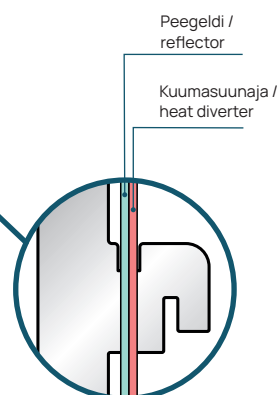

Jälgi, et mõlemad asetuks kandurites olevatesse vahedesse /
Make sure that both are fixed in the gaps in the carriers.

EE Kuumasuunaja paigaldamine kividega täidetud kerisele

Kuumasuunaja paigaldamiseks juba seinale kinnitatud ja kividega täidetud DROP kerisele:

- 1 Lao pooled kivid välja, et saaksid kerist ilma ribisid kahjustamata kergitada.
- 2 Tõsta kerist ja kalluta veidi ette poole, jättes see alumiste kanduritega seinaraamile toetuma.
NB! Jää kerist toetama!
Paigalda kuumasuunaja kerise tagumisele küljele.
- 3 Tõsta keris tagasi seinaraamile, keera kinni paremal küljel asuv turvapolt ning täida keris kividega.

EN Installation of a heat diverter on a heater filled with stones

To install the heat diverter on a DROP heater already attached to the wall and filled with stones:

- 1 Remove about half of the stones to lighten the heater, ensuring that you don't damage the ribs.
- 2 Lift the heater and slightly tilt it forward. It should still rest on the wall frame using the lower supports.
NB! Maintain a firm hold on the heater!
Install the heat diverter on the heater's back side.
- 3 Place the heater back on the wall frame, tighten the security bolt on the right side, and refill the heater with the stones.

Jälgi, et peegeldi ja kuumasuunaha asetuks kandurites olevatesse vahedesse /
Make sure that the reflector and the heat diverter are fixed in the gaps in the carriers.

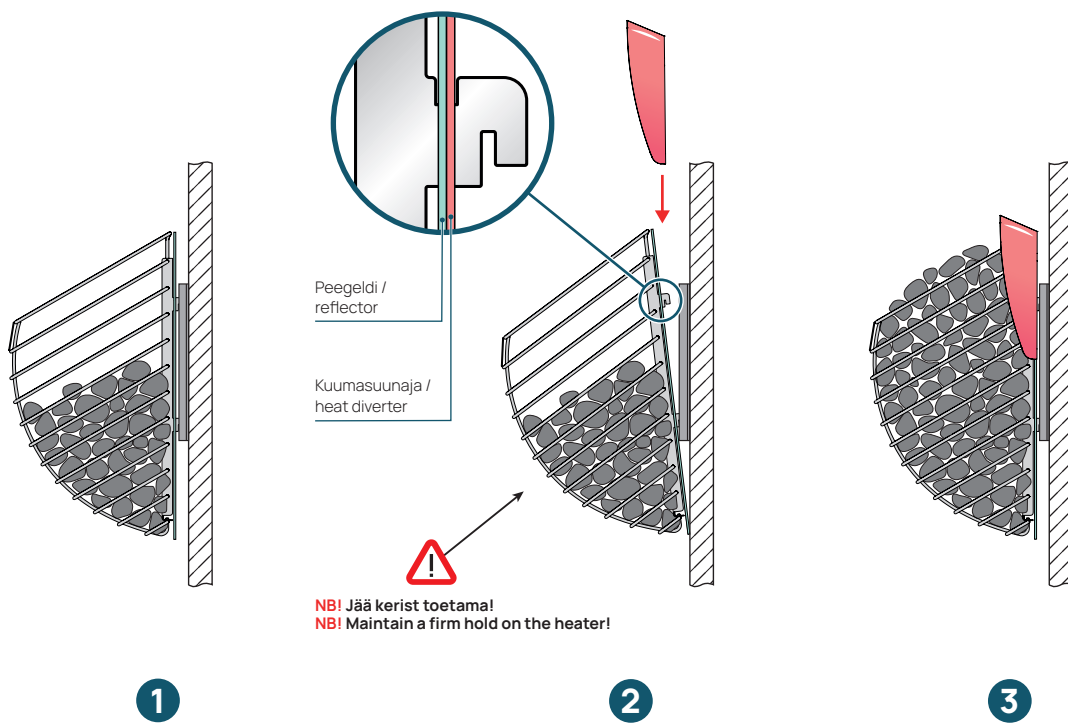

DROP



Made in Estonia, EU

info@huum.eu
huum.eu
#huumsauna

HUUM OÜ
Vahi tee 9, Tartumaa
60534, Estonia